

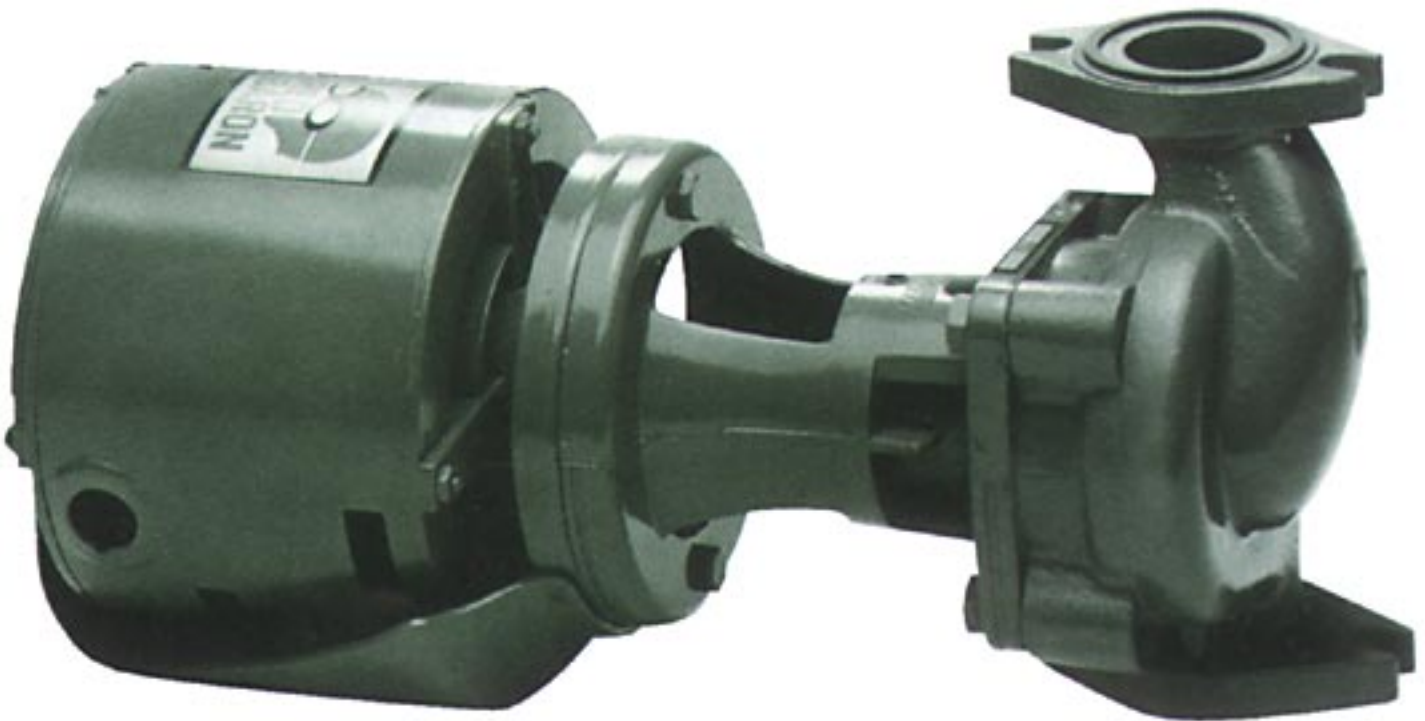

COMPARE. YOU'LL TAKE TACO.

---

## IN-LINE™ CIRCULATORS



**Designed to efficiently circulate heated or chilled water in residential, commercial hydronic or solar systems. Ideal for primary-secondary systems, as well as parallel pumping designs. These circulators may also be used for zoning large installations and are available in bronze construction for fresh water and domestic hot water applications.**

---

### **TACO, INC.**

1160 Cranston Street, Cranston, RI 02920  
Telephone (401) 942-8000 Telex: 92-7627

### **TACO (Canada) LTD.**

1310 Aimco Blvd., Mississauga, Ontario L4W 1B3  
Telephone (416) 625-2160 Telex: 06-961179

# Series 110 – 120

## 110, 111, 112, 113, 120 RED BARON CIRCULATORS

### APPLICATIONS

Designed to efficiently circulate heated or chilled water in residential or light commercial hydronic systems. These circulators may also be used for zoning large installations and are available in bronze construction for domestic hot water applications.

### FEATURES

**Proven Performance** — The Red Baron Circulators are backed by over 45 years of Taco experience in design and manufacture of standard circulators. Millions of 110s are in service — the 110 Red Baron is Taco's most popular residential seal-type circulator.

**Dependable — Quiet Operation** — The Red Barons offer quiet, dependable pumping power and long-lasting performance. These dependable circulators are standard equipment on many OEM boilers.

### BUILT TO LAST

**Rugged Motor** • Resilient mounted, split phase motor with built-in overload protector • Equipped with sleeve bearings for quiet operation.



**Proven Pump Construction** • One piece dynamically balanced impeller • Stainless steel shaft • Rugged bronze sleeve bearing • Two-piece carbon/ceramic seal assembly • Durable one-piece spring coupling.

**Factory Tested** • Every circulator is operated before shipment.

**Easy, Low-cost Service** • No special tools required • Nationwide parts availability.

**Accessories & Cast Iron Options** • Available in all bronze construction • Standard cast iron flanges ¾, 1, 1¼, 1½ • Shut-off flanges assure ease of service. Available in ¾", 1", and 1¼" connections.

## SPECIFICATIONS And DIMENSIONS

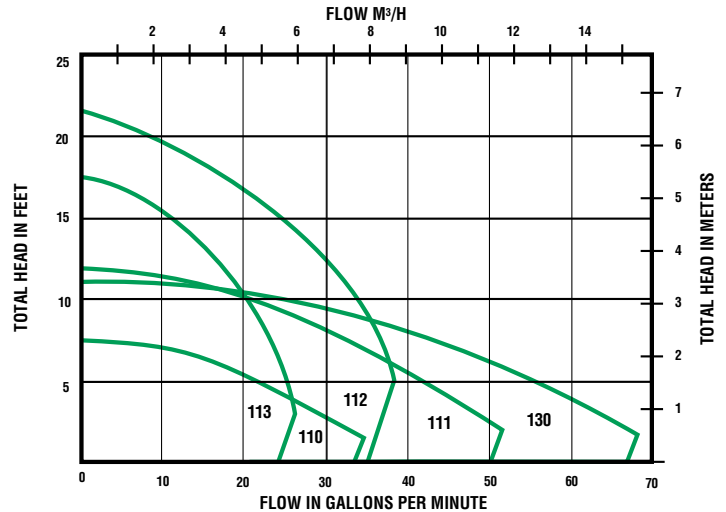
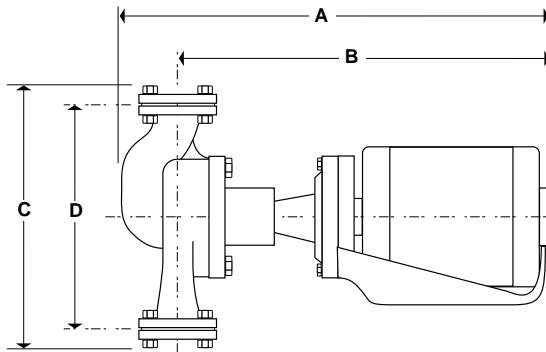

Product Number <sup>1</sup>	Flange Size	Motor <sup>2</sup>		Maximum Temp. <sup>3</sup>	Pressure Rating	Dimensions								Approx. Ship. Wt.	
		115V 60C 1 PH	RPM			A		B		C		D		LBS	KG
						IN.	MM	IN.	MM	IN.	MM	IN.	MM		
110	¾", 1" 1¼", 1½"	1/12	1725	240° F	125 psi	14 <sup>5</sup> / <sub>8</sub>	371.5	12 <sup>5</sup> / <sub>8</sub>	320.7	7 <sup>1</sup> / <sub>8</sub>	200	5 <sup>1</sup> / <sub>16</sub>	160.3	21	9.5
111	¾", 1" 1¼", 1½"	1/8	1725	240° F	125 psi	16 <sup>1</sup> / <sub>4</sub>	412.8	13 <sup>7</sup> / <sub>8</sub>	352.4	10 <sup>1</sup> / <sub>4</sub>	260.4	8 <sup>3</sup> / <sub>4</sub>	222.3	26	11.8
112	¾", 1" 1¼", 1½"	1/3	3450	240° F	125 psi	16 <sup>1</sup> / <sub>2</sub>	419.1	14 <sup>1</sup> / <sub>2</sub>	368.3	7 <sup>1</sup> / <sub>8</sub>	200	6 <sup>3</sup> / <sub>8</sub>	161.9	28	12.7
113	¾", 1" 1¼", 1½"	1/8	1725	240° F	125 psi	16 <sup>1</sup> / <sub>4</sub>	412.8	14	355.6	10 <sup>1</sup> / <sub>8</sub>	257.2	8 <sup>1</sup> / <sub>2</sub>	215.9	27	12.2
120	2"	1/6	1725	240° F	125 psi	16 <sup>7</sup> / <sub>8</sub>	428.6	14 <sup>1</sup> / <sub>4</sub>	362	13 <sup>1</sup> / <sub>2</sub>	342.9	11	279.4	46	20.9

1. When specifying all bronze construction add letter "B" after product number, ie: 110B

2. Motors are available with other electrical characteristics — consult your Taco representative.

3. 240° Intermittent; 200° Continuous.

# Series 121 – 138

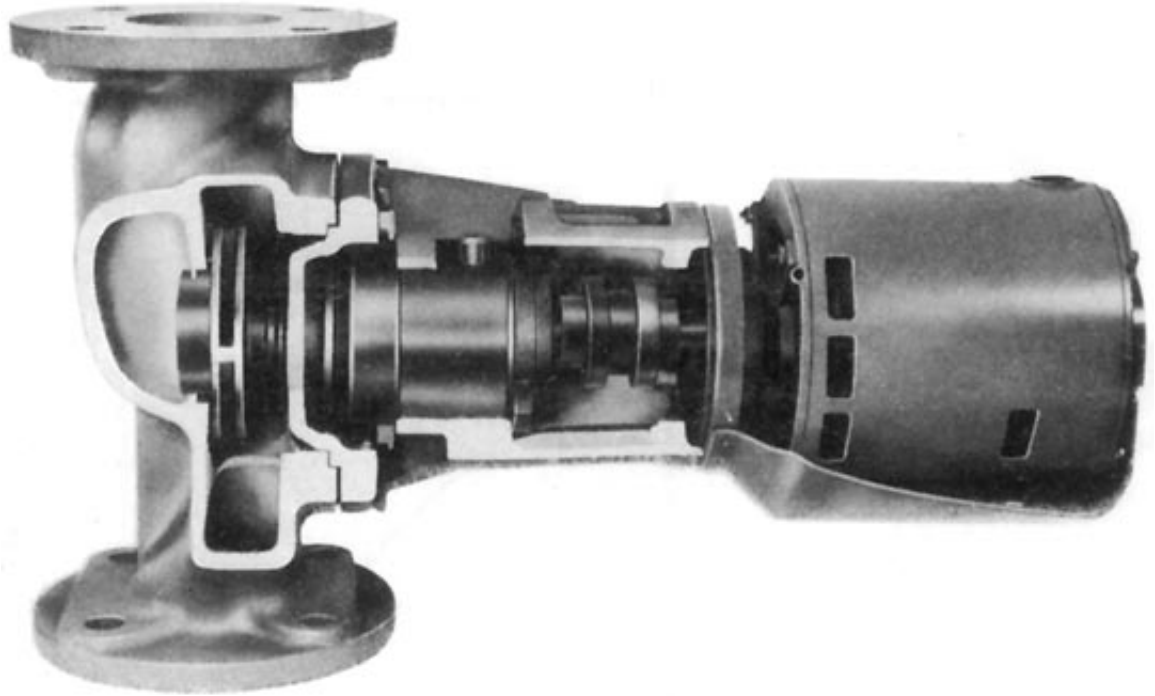

## IN-LINE CARTRIDGE DESIGN PUMPS

### APPLICATIONS

Designed to efficiently circulate heated or chilled water in large residential and commercial hydronic or solar systems. Ideal for primary-secondary systems, as well as parallel pumping designs. Available in bronze construction for fresh water service.

### FEATURES

**Proven Performance** — In-Line Cartridge Design Pumps are backed by over 42 years of Taco experience in design and manufacture of circulators. Tens of thousands are in service.

**Dependable** — Quiet Operation — In-Line Cartridge Design Pumps offer quiet, dependable pumping power and long-lasting performance. Ideal for heating and/or air conditioning systems requiring high head performance with relatively low volume.

**Unique Cartridge Design** — The Taco “Cartridge” pumps are the first in-line pumps to be specifically designed for hot water service. The unique cartridge design allow operation in systems up to 300°F. Bearing lubricant is isolated from the effects of the system fluid temperature.

The Taco Cartridge pumps are the only in-line pumps having a centrifugal lubrication system. A dip stick is provided to check the oil level and a drain plug is provided to change the oil when necessary.

### BUILT TO LAST

**Cartridge Bearing Assembly** • Centrifugal lubrication system — filled at the factory • Extra heavy journal bearings and thrust bearings — separately lubricated • Lip type oil seals to prevent leakage • Alloy steel shaft • Cupro-Nickel shaft sleeve.

**Mechanical Seal** • Two-piece carbon/ni-resist seal is standard • Carbon/ceramic standard on bronze models • Carbon/tungsten carbide available for high temperature applications.

**Body & Flanges** • Available in cast iron or bronze • In-Line configuration • Companion flanges provided in 2½" or 3".

**Impeller** • Dynamically and hydraulically balanced • Enclosed type — cast iron or bronze.

**Drive Coupling** • Rugged, flexible rubber construction ... absorbs angular and parallel misalignment.

**Rugged Motor** • Available in single and three phase, and all standard voltages ... open-drip proof enclosure • Equipped with sleeve bearings for quiet operation • Resilient mounted • Built-in overload protector on single phase models.

**Factory Tested** • Every pump is operated before shipment.

**Easy, Low-Cost Service** • No special tools required • One Cartridge bearing assembly fits all models — replace cartridge only ... not bracket • One mechanical seal fits all models.

# Series 121 – 138

## SPECIFICATIONS and DIMENSIONS

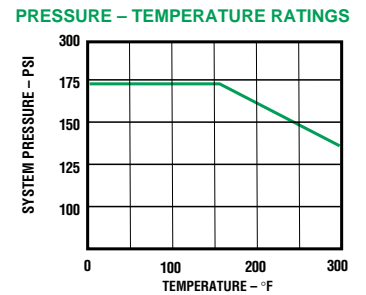
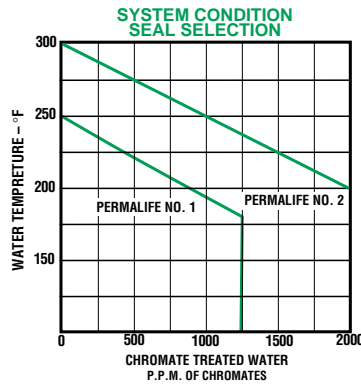
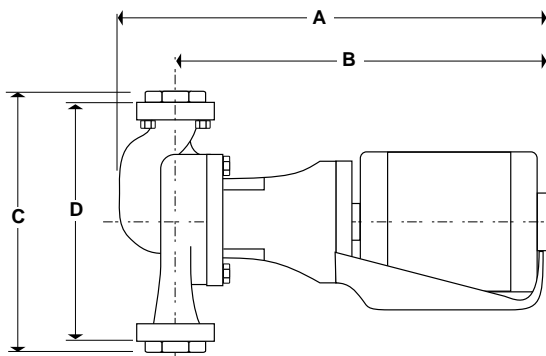
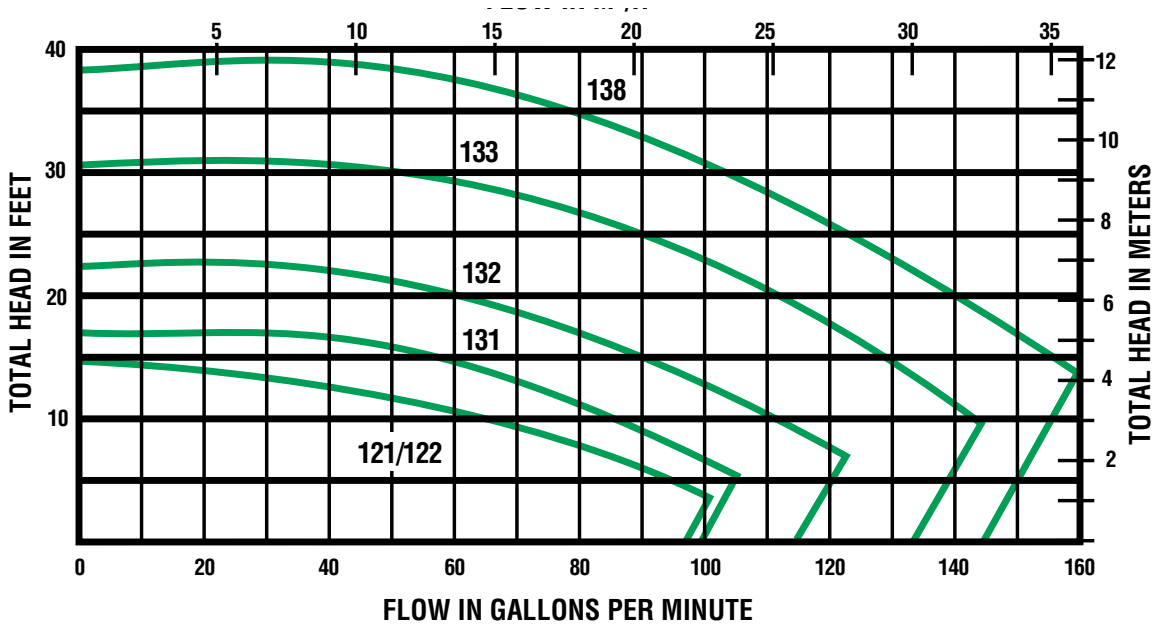

Product Number <sup>1</sup>	Flange Size	Motor <sup>2</sup>		Dimensions								Approx. Ship. Wt.	
		60C/AC 1 PH	RPM	A		B		C		D		LBS	KG
				IN.	MM	IN.	MM	IN.	MM	IN.	MM		
121	2½"	¼ HP, 115V	1725	18⅞	460.4	15⅞	403.2	14¼	362	11⅞	282.6	72	32.7
122	3"	¼ HP, 115V	1725	18⅞	460.4	15⅞	403.2	13⅞	346.1	11⅞	282.6	72	32.7
131	3"	⅓ HP, 115V	1725	19¼	489	15¾	400.1	16	406.4	13⅝	346.1	95	43.1
132	3"	¾ HP, 115/230V or 230/460/60/3 or 200/60/3	1725	21½	546.1	18	457.2	16	406.4	13⅝	346.1	108	49.0
133	3"	¾ HP, 115/230V	1725	22⅞	562	18⅞	473.1	16	406.4	13⅝	346.1	113	51.3

- When specifying all bronze construction add letter "B" after product number, ie: 110B. When specifying bronze fitted construction, add letter "C" after product number, ie: 132C.
- Motors are available with other electrical characteristics — consult your Taco representative.