



COMPARE. YOU'LL TAKE TACO.

Model 0012 High Velocity Circulator



- **Motor Winding Protector—Exclusive ACB Anti-Condensate Baffle with Ambient Air Flow Protects Motor Windings Against Condensate Buildup**
- **Unique Replaceable Cartridge Design—Field Serviceable/RP Parts Available**
- **Quiet, Efficient Operation—No Maintenance/No Mechanical Seals**
- **Compact Design—High Velocity Performance**
- **Direct Drive—Low Power Consumption**
- **Universal Flange to Flange Dimensions—Cast Iron or Bronze Construction**
- **Manufactured in a Variety of Sizes to Match System Requirements**
- **Residential and Light Commercial Applications**

TACO, INC.

1160 Cranston Street, Cranston, RI 02920
Telephone (401) 942-8000 Telex: 92-7627

TACO (Canada) LTD.

1310 Aimco Blvd., Mississauga, Ontario L4W 1B2
Telephone (416) 625-2160 Telex: 06-961179

"00" Series Cartridge Circulators

Submittal Data Information



APPLICATION

The Taco 0012 high velocity/high flow circulator is designed for residential and light commercial closed loop hydronic systems and open loop domestic fresh water systems. This circulator is available in cast iron or bronze construction and features the exclusive "00" cartridge design and ACB motor protector. The "00" cartridge contains all the moving parts. Replacing it virtually rebuilds the circulator. The unique ACB anti-condensate baffle with ambient air flow prevents the buildup of condensate on the motor windings when pumping chilled water. The 0012 has a high flow medium head characteristic for applications in large BTUH boilers, 2" replacement

recirculation loops, primary secondary loops, commercial water heaters, and light commercial heating and cooling systems. The quiet, direct-drive 0012 high velocity series contains no mechanical seal and requires no maintenance. This compact design has low power consumption and is ideal for those high efficiency jobs that have space requirements. Because universal flange to flange length and orientation is featured, the 0012 may easily replace other models. The 0012-F1 is a direct replacement to the HV series and the 0012F1-1 is a direct replacement to the 2" series using the existing flanges.

PUMP DIMENSIONS

Model No.	A		B		C		D		F		G		Shipping Weight	
	IN.	MM	IN.	MM	IN.	MM	IN.	MM	IN.	MM	IN.	MM	LBS.	KG
0012-F2	8 ⁵ / ₈	219	6 ³ / ₈	162	4 ¹ / ₄	108	3 ⁷ / ₈	98	6	152	8 ¹ / ₂	216	14.0	6.4
0012F2-1	9	229	6 ³ / ₈	162	4 ¹ / ₄	108	3 ⁷ / ₈	98	6	152	8 ¹ / ₂	216	14.0	6.4

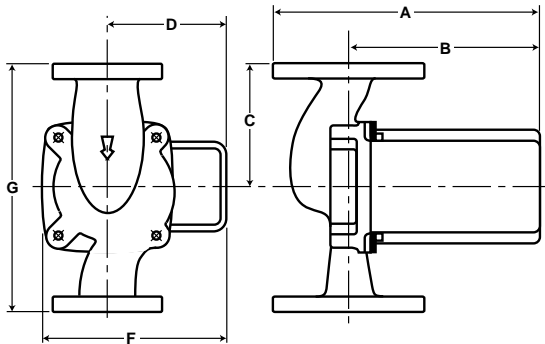

SPECIFICATIONS UL & CSA LISTED

ACB BAFFLE	Non-Ferrous
CASING*	Cast Iron or Bronze
IMPELLER	Non-Metallic
SHAFT	Ceramic
BEARINGS	Carbon
CONNECTIONS	Flanged H/V—1 ¹ / ₄ , 1 ¹ / ₂ 2"—1 ¹ / ₂
PRESSURE RATING	125 psi Maximum
TEMPERATURE RATING	220°F Maximum
MOTOR TYPE	Permanent Split Capacitor
HP	1/8 HP @ 3250 RPM
ELECTRICAL CHAR:	115/60/1 1.7 Amp Rating Impedance Protected

*Use bronze construction for open loop applications.

PERFORMANCE FIELD

